



BakeMax BMREF Titan Series Refrigerated Countertop Display Operations Manual



Questions? OEM Parts, Contact Us:

Toll Free: 1-800-565-2253

Email: Info@BakeMax.com

www.BakeMax.com

Warranty Registration

www.BakeMax.com/Warranty-Registration



Warning & Safety

PLEASE READ AND FOLLOW INSTRUCTIONS BELOW TO PREVENT INJURY OR DAMAGE TO THE PRODUCT

BakeMax® (a registered trademark of Titan Ventures International Inc or TVI) is not responsible for any harm or injury caused due to any person's improper or negligent use of this equipment. The product shall only be operated by someone over the age of 18, of sound mind, and not under the influence of any drugs or alcohol, who has been trained in the correct operation of this machine, and is wearing authorized, proper safety clothing. This machine is intended for commercial use only. Any modification or miss use to the machine voids any warranty and may cause harm to individuals using the machine or in the area of the machine while in operation.

- When using the machine, please ensure that you have read all of the instructions within this manual.
- Be aware of your surroundings when using this machine, ensure there are no children or any other persons who are near the machine before operating.
- Do not put hand near moving parts.
- Remove all obstacles, which may interfere with machine functions.
- Keep work area clean and clear of clutter.
- Do not sit or stand on machine.
- Do not wear loose clothing or jewellery when operating machine as it may get caught in moving parts and cause injury.
- Stop using the machine and have it checked by an authorized service personal if it is not working properly.
- Disconnect from power source before performing and maintenance or cleaning on the machine.
- When the machine is not in use, please clean and store properly,
- Do not place any electrical parts or plug / cord in water or liquid.
- If the supply cord is damaged it must be replaced by an authorized service agent in order to avoid any electrical hazards.
- Keep power cord away from heat.
- Always ensure to follow local laws when operating your machine.

Product Installation & Set Up

- After unpacking and cleaning your new countertop refrigerated showcase. Let it sit upright for at least 24 hours before plugging it in. Never tilt machine more than 45°. If the unit is laid on its side to be moved, let the unit sit fully upright for 24 hours before plugging it back in.
- Make sure all accessories are installed (shelves, shelf clips, etc...) before plugging in the unit.
- Ensure the unit is placed on a smooth, level flat surface.
- The display case should be kept away from heat, humidity and dusty areas as it can cause stress on the unit.
- During high humidity days, condensation may be found on the outside of the refrigerator. This is not a problem, this is caused by high ambient humidity. Simply use a cloth to wipe it. **Note:** This unit is for indoor use only.
- Ensure there is at least 6" space available on each side for air to properly circulate around the unit.
- Never block the air suction inlet or air vents.
- Make sure the unit has reached the desired temperature before loading the unit with products.
- Ensure any items that are warm / hot to be cooled before placing in the unit.
- Minimize the time with the door is open and reduce opening and closing frequently.
- Do not overfill the unit or it may hinder its operation.
- Adjust the rack height for proper food storage.
- After power outage or unplugging the refrigerator, always wait at least 5 minutes before starting the refrigerator again.
- Never put any flammable or explosive items inside the refrigerator such as gasoline or alcohol. Never put any dangerous product near the refrigerator.
- Do not store medication in the refrigerator.

Warranty Notes: Malfunction due to high ambient temperatures, humidity, or improperly maintained condenser coil will void the warranty. Failure to properly maintain the unit will also void the warranty. This includes, but is not limited to, basic preventative maintenance like cleaning the condenser coil. Any damage that occurs as a result of negligence or improper handling. Overloading or improper loading of the unit in a manner that prevents proper airflow.



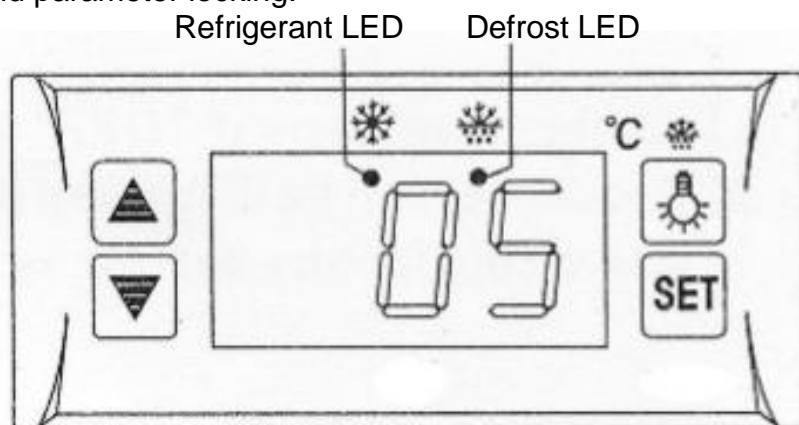

Digital Temperature Controller

The digital temperature controller is easy to operate and controls the compressor.

- The main functions are: Temperature display, manual control, automatic defrost, light control, value storing, self-testing and parameter locking.



Front Panel Operation

1. How to Set temperature
Press “set” button, the set temperature is displayed.
Press  or  button to modify and store the displayed value.
Press “set” button to exit the adjustment and display the cold-room temperature.
2. If no more button is pressed within 10 seconds, the cold-room temperature will be displayed.
3. Lights: Press  button to turn them on and off.
Manual start/stop defrost: Press  button and hold for 6 seconds to defrost or stop defrost.
4. Refrigerant LED: During refrigeration, the LED is on; When the cold room temp. is constant, the LED is off; During the delay start, the LED flashes.
5. Defrost LED: during defrosting, the LED is on; When is stops defrosting, the LED is off, During the delay display of defrost, the LED flashes.

Cleaning & Maintenance

- This unit has been coated for shipping purposes, please clean before use. Dip a soft cloth in neutral detergent (dish detergent) to clean the outside of the refrigerator and then wipe it with a dry soft cloth.
- Do not use any liquid pressurised cleaning equipment on this machine.
- Disconnect power supply before cleaning.
- Only use food grade non abrasive cleaning agents.

Keep the refrigerator clean and periodic maintenance is necessary. Always unplug the power cord before maintenance. Never use a damaged plug or loose socket to prevent electric shock or short circuiting. Never flush the refrigerator. Never use alkaline detergent, soap, gasoline, acetone or bush.

Cleaning the Condenser Coil

- For efficient operation, keep the condenser surface free of dust, dirt, and lint.
- We recommend cleaning the condenser coil at least once per month.
- Clean the condenser with a commercial condenser coil cleaner, available from any kitchen equipment retailer.

Cleaning the Fan Blades and Motor

- If necessary, clean the fan blades and motor with a soft cloth.
- If it is necessary to wash the fan blades, cover the fan motor to prevent moisture damage.

Shutting Down the Unit For Extended Period of Time

- Take out all food and unplug the wall socket. Clean both inside and outside of the refrigerator thoroughly and open the door to sufficiently dry. Leave door open when storing for long periods of time. Clean the condensate tray and wipe dry.

Technical Specifications

- BMREF28 Exterior Dimensions (WDH): 27.6" x 22.5" x 27"
- BMREF35 Exterior Dimensions (WDH): 35.4" x 22.5" x 27"
- Electrical: 120v / 15 Amps / 230 watts / 60Hz / 1Ph
- Nema: 5-15P Plug
- BMREF28 Net Weight: 141 lb / 64 kg
- BMREF35 Net Weight: 156 lb / 71 kg

Troubleshooting

Problem	Possible Cause	Remedy
No Refrigeration / Compressor is Not Running	Fuse blown or circuit breaker tripped.	Replace fuse or reset circuit breaker
	Power cord unplugged	Plug in power cord.
	Thermostat set too high.	Set thermostat to lower temperature.
	Cabinet in defrost cycle.	Wait for defrost cycle to finish
Cabinet Temperature is too Warm	Thermostat is set too high.	Set thermostat to lower temperature.
	Airflow is blocked.	Ensure there is at least 6" of space available around the unit. Make sure the ducts are not blocked. Make sure the inside of the unit is not over filled.
	Low refrigerant levels.	Contact an authorized service technician to check refrigerant levels.
	Door is slightly ajar.	Make sure door(s) is completely closed.
	External heat source.	Make sure the unit is away from direct sunlight and other sources of heat.

The following situations are not problems:

- The murmur of water is heard when the refrigerator is working. This is normal as the coolant is circulating in the system.
- During high humidity days, condensation may be found on the outside of the refrigerator. This is not a problem, this is caused by high ambient humidity. Simply use a cloth to wipe it.

BakeMax BMREF28 Parts Break Down

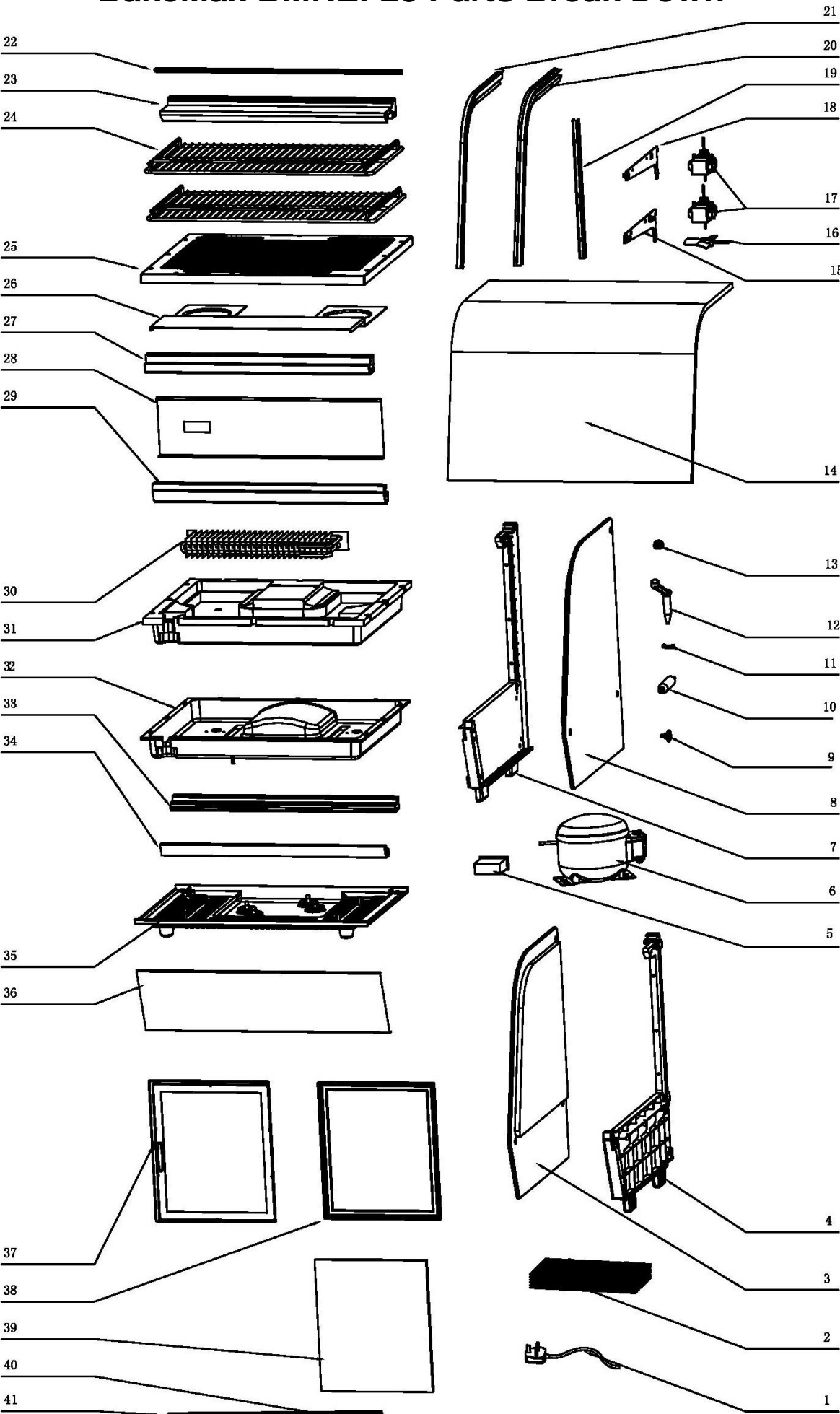

Position	Description		Position	Description		Position	Description
1	Power Cord		15	Left Shelf Bracket		29	Front Middle Pillar
2	Condenser		16	Fan Blade		30	Evaporator
3	Left Glass		17	Motor Fan		31	Foam Base of Evaporator
4	Left Panel		18	Right Shelf Bracket		32	Plastic Base for Foam
5	Digital Controller		19	Pillar for Bracket		33	Rear Bottom Pillar
6	Compressor		20	Left Seal		34	Front Bottom Pillar
7	Right Panel		21	Right Seal		35	Bottom Base of Compressor for
8	Right Glass		22	Decorative Board		36	Front Frame
9	Glass Screw		23	Top Panel		37	Outer Door frame
10	Accumulator		24	Shelf 1		38	Inner Door Frame
11	Wire Clip		25	Vent Tray		39	Door Glass
12	Water Pipe		26	Evaporator Protect Board		40	LED Light
13	Motor Fixer		27	Rear Middle Pillar		41	LED Power
14	Curved Front Glass		28	Rear Base Panel			

BakeMax BMREF35 Parts Break Down

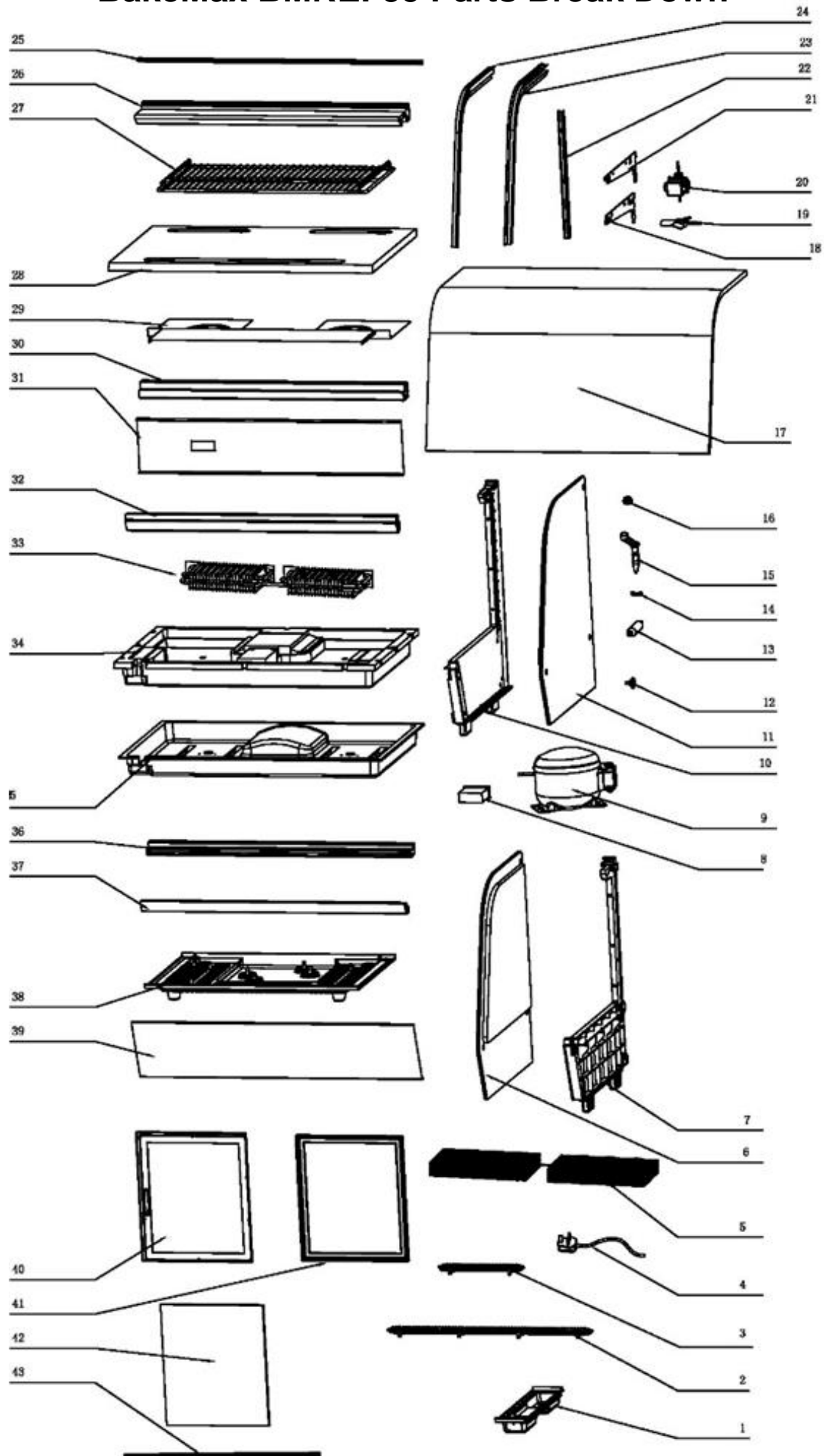

Position	Description
1	Water Tray
2	Cover for Air Outlet
3	Cover for Air Suction
4	Power Cord
5	Condensator
6	Left Glass
7	Left Panel
8	Digital Controller
9	Compressor
10	Right Panel
11	Right Glass
12	Glass Screw
13	Accumulator
14	Wire Clip
15	Water Pipe

Position	Description
16	Motor Fixer
17	Curved Front Glass
18	Left Shelf Bracket
19	Fan Blade
20	Motor Fan
21	Right Shelf Bracket
22	Pillar for Bracket
23	Left Seal
24	Right Seal
25	Decorative Board
26	Top Panel
27	Shelves
28	Vent Tray
29	Evaporator Protect Board
30	Rear Middle Pillar

Position	Description
31	Rear Base Panel
32	Front Middle Pillar
33	Evaporator
34	Foam Base of Evaporator
35	Plastic Base for Pillar
36	Rear Bottom Pillar
37	Front Bottom Pillar
38	Bottom Base of Compressor for
39	Front Frame
40	Outer Door Frame
41	Inner Door Frame
42	Door Glass
43	LED Light

Warranty & Service

One year parts and labor limited warranty on most items, there are select items which carry a two year warranty. Extended warranty is available on some products. Contact us for details.

For all warranty claims, proof of purchase is required.

Warranty begins 10 days after shipping from warehouse; delays in installation which would extend the warranty must be approved.

All equipment must be installed and connected by qualified professionals in accordance with the manual specification.

Any abuse of equipment or improper use of machinery will void the warranty. Including failure to follow all instructions in operations manual. Properly install, maintain equipment, follow capacity charts, or electrical information.

Accessories, attachments, or electrical components such as fuses, bulbs, elements and switches are covered under a 90 day warranty. Repairs include Parts and Labor only, excluded is the following:

1. Overtime Labor Rates
2. Expedited Freight for Parts
3. BakeMax assumes no responsibility for down time or loss of product. All defective parts must be returned to BakeMax for credit. Repairs must be pre-authorized by BakeMax prior to work commencing.
4. Travel time is not covered by BakeMax, unless pre-authorized by BakeMax.

Bench Warranty (Machines Weighing 100 lb or less)

For all warranty claims proof of purchase is required to claim warranty. One year parts and labor warranty, from date of purchase.

Once machine is approved for warranty, the machine is to be shipped prepaid to authorized service depot. Customer will ship machine prepaid to authorized service depot. If machine requires warranty work in less than 30 days of purchasing BakeMax will pay all shipping charges. (Freight damages during shipping for warranty is the responsibility of the owner of the machine.)

Once machine is received and repaired it will be returned to the user at BakeMax expense.



*****BakeMax machines sold outside of the continental North America will carry one year parts warranty only.***

Titan Ventures International (TVI)
170 Millennium Blvd, Moncton, NB, E1E 2G8
Toll Free: 1-800-565-BAKE (2253)
Telephone: 1-506-858-8990
Fax: 1-506-859-6929
Email: Info@BakeMax.com

BakeMax is a Registered Trade Mark of Titan Ventures International Inc.

BakeMax ® / Titan Ventures International Inc.

Warehouses:

170 Millennium Blvd, Moncton, NB, E1E2G8 
1605 Crescent Circle, Dallas, TX 75006 

Toll Free: 1-800-565-BAKE (2253)
Phone: 506-858-8990
Fax: 506- 859-6929
Email: Sales@BakeMax.com